

ORDER BY PART NUMBER

# ILLUSTRATED PARTS

## U.3712LS U.3713X

Georgian Era High Neck Widespread Bathroom Faucet

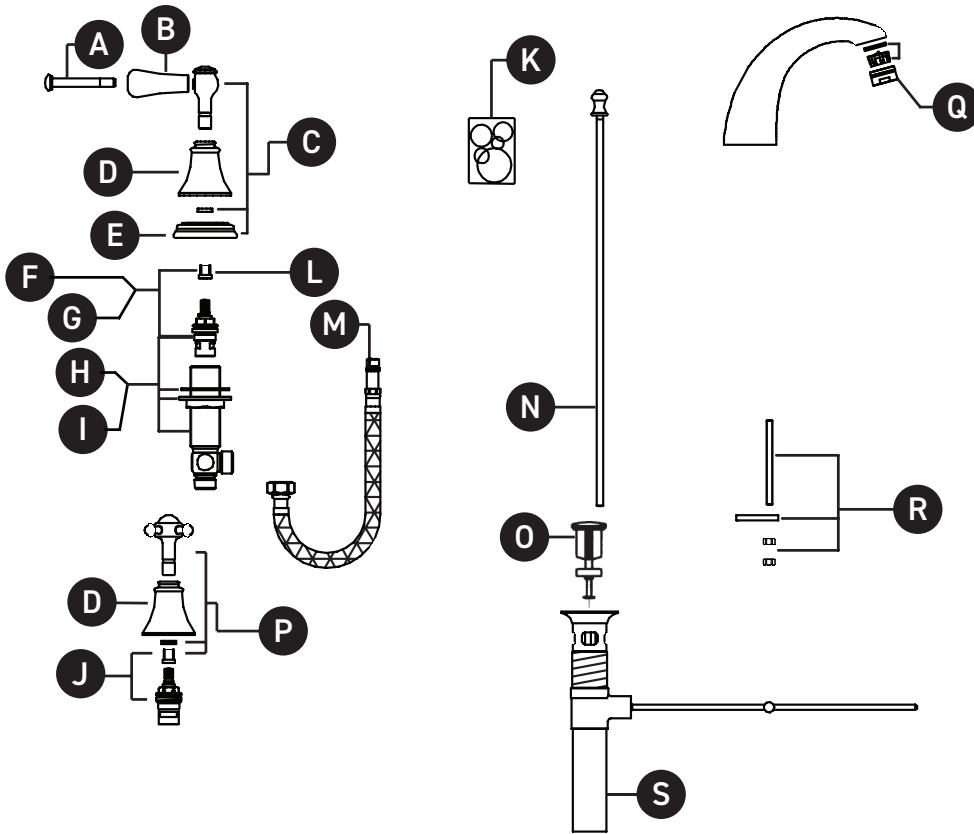

| ID | Kit Number   | Finish    |
|----|--------------|-----------|
| A* | 9.24194      | See below |
| B* | 9.26760      | See below |
| C* | 9.21198K     | See below |
| D* | 9.12752      | See below |
| E* | 9.18380      | See below |
| F  | 9.13195 (C)  | N/A       |
| G  | 9.13196 (H)  | N/A       |
| H  | 9.30195 (H)  | N/A       |
| I  | 9.30196 (C)  | N/A       |
| J  | 9.13196 (H)  | N/A       |
| K  | 9.53723      | N/A       |
| L  | 9.15402      | N/A       |
| M  | 9.28400      | N/A       |
| N* | 9.51786      | See below |
| O* | 9.26709      | See below |
| P* | 9.01797C (C) | See below |
|    | 9.01797H (H) | See below |
| Q* | 9.19653      | See below |
| R  | 9.26400      | N/A       |
| S  | 9.26705      | N/A       |

**\*Finish Determined by Suffix**

| Finish | Description       |
|--------|-------------------|
| APC    | Polished Chrome   |
| EB     | English Bronze    |
| EG     | English Gold      |
| PN     | Polished Nickel   |
| STN    | Satin Nickel      |
| ULB    | Unlacquered Brass |

For warranty or additional information, contact:

U.S.A.  
houseofrohl.com/support  
1-800-777-9762

QUEBEC / MARITIMES / WESTERN CANADA  
QUÉBEC / MARITIMES / OUEST CANADIEN  
QUEBEC / MARITIMOS / CANADA OCCIDENTAL  
houseofrohl.ca/support  
1-866-473-8442

ONTARIO  
houseofrohl.ca/support  
1-800-287-5354

VEUILLEZ EFFECTUER VOTRE COMMANDE  
PAR NO DE RÉFÉRENCE

# ILLUSTRATIONS DES PIÈCES

## U.3712LS U.3713X

Robinet de salle de bain espacé à col  
haut Georgian Era

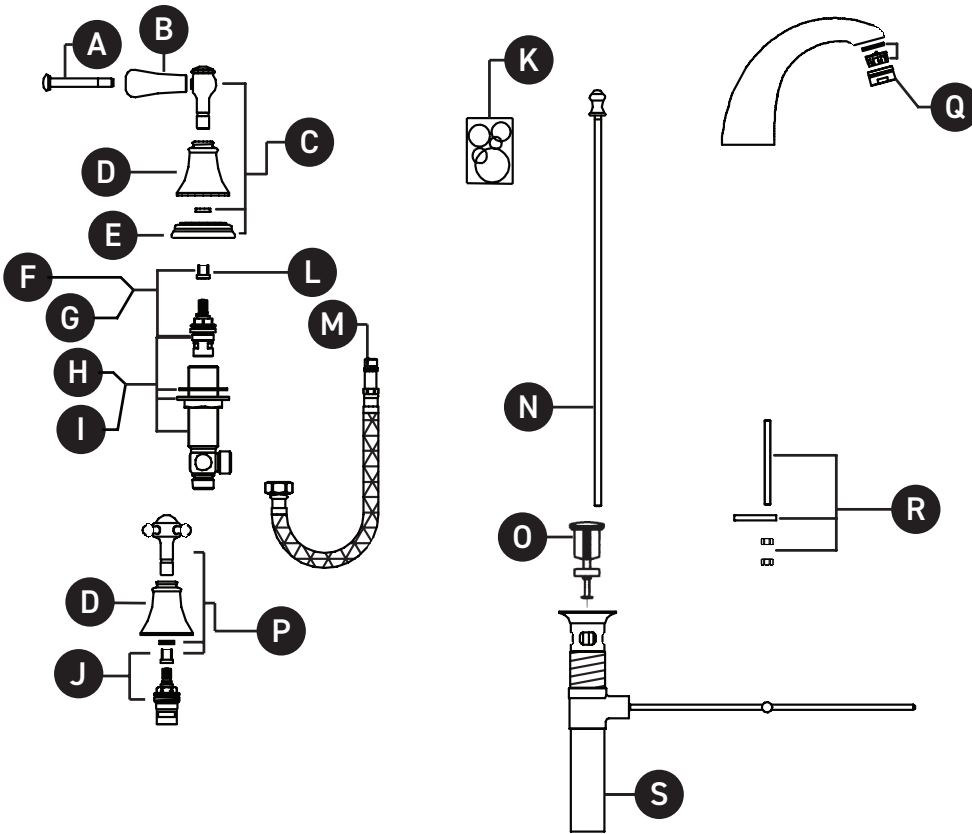

| ID | Référence du kit | Finition        |
|----|------------------|-----------------|
| A* | 9.24194          | Voir ci-dessous |
| B* | 9.26760          | Voir ci-dessous |
| C* | 9.21198K         | Voir ci-dessous |
| D* | 9.12752          | Voir ci-dessous |
| E* | 9.18380          | Voir ci-dessous |
| F  | 9.13195 (C)      | N/A             |
| G  | 9.13196 (H)      | N/A             |
| H  | 9.30195 (H)      | N/A             |
| I  | 9.30196 (C)      | N/A             |
| J  | 9.13196 (H)      | N/A             |
| K  | 9.53723          | N/A             |
| L  | 9.15402          | N/A             |
| M  | 9.28400          | N/A             |
| N* | 9.51786          | Voir ci-dessous |
| O* | 9.26709          | Voir ci-dessous |
| P* | 9.01797C (C)     | Voir ci-dessous |
|    | 9.01797H (H)     | Voir ci-dessous |
| Q* | 9.19653          | N/A             |
| R  | 9.26400          | N/A             |
| S  | 9.26705          | N/A             |

**\*Finition déterminée par le Suffixe**

| Finition | Description      |
|----------|------------------|
| APC      | Laiton poli      |
| EB       | Bronze anglais   |
| EG       | Or anglais       |
| PN       | Nickel poli      |
| STN      | Nickel satiné    |
| ULB      | Laiton non laqué |

For warranty or additional information, contact:

U.S.A.  
houseofrohl.com/support  
1-800-777-9762

QUEBEC / MARITIMES / WESTERN CANADA  
QUÉBEC / MARITIMES / OUEST CANADIEN  
QUEBEC / MARITIMOS / CANADA OCCIDENTAL  
houseofrohl.ca/support  
1-866-473-8442

ONTARIO  
houseofrohl.ca/support  
1-800-287-5354

PEDIR POR NÚMERO DE REFERENCIA

# PIEZAS ILUSTRADAS

## U.3712LS U.3713X

Grifo de baño generalizado de cuello alto de la era georgiana

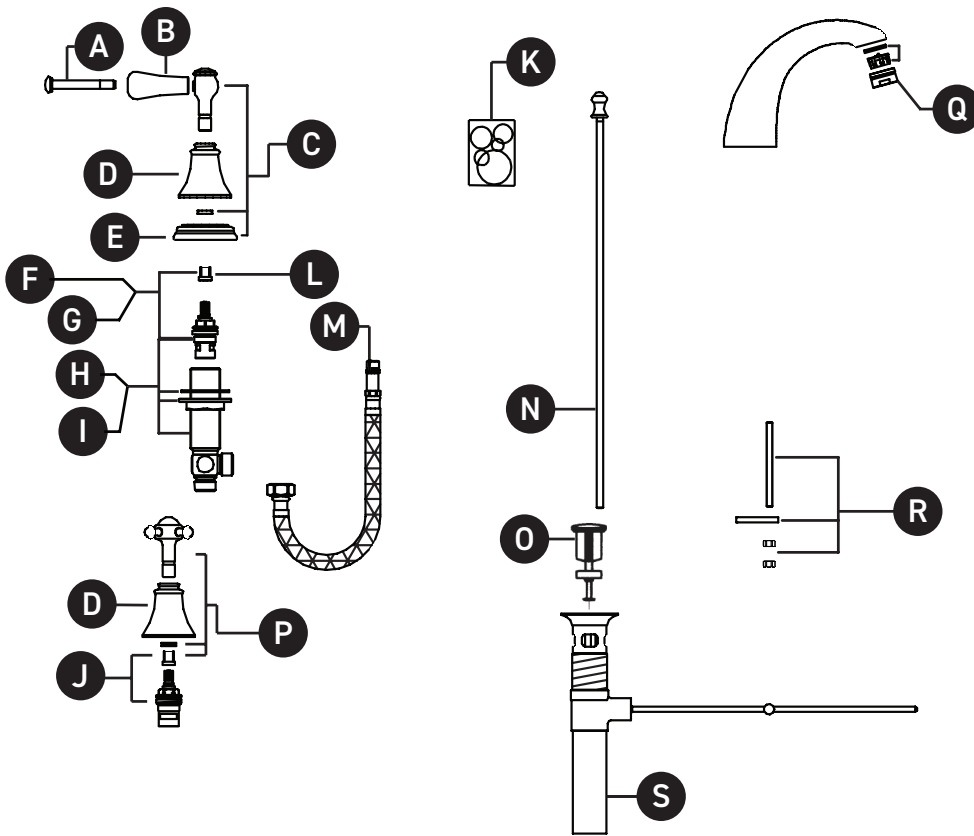

| ID | Referencia del kit | Acabado       |
|----|--------------------|---------------|
| A* | 9.24194            | Ver más abajo |
| B* | 9.26760            | Ver más abajo |
| C* | 9.21198K           | Ver más abajo |
| D* | 9.12752            | Ver más abajo |
| E* | 9.18380            | Ver más abajo |
| F  | 9.13195 (C)        | N/A           |
| G  | 9.13196 (H)        | N/A           |
| H  | 9.30195 (H)        | N/A           |
| I  | 9.30196 (C)        | N/A           |
| J  | 9.13196 (H)        | N/A           |
| K  | 9.53723            | N/A           |
| L  | 9.15402            | N/A           |
| M  | 9.28400            | N/A           |
| N* | 9.51786            | Ver más abajo |
| O* | 9.26709            | Ver más abajo |
| P* | 9.01797C (C)       | Ver más abajo |
|    | 9.01797H (H)       | Ver más abajo |
| Q* | 9.19653            | N/A           |
| R  | 9.26400            | N/A           |
| S  | 9.26705            | N/A           |

**\*Acabado determinado por el sufijo**

| Acabado | Descripción     |
|---------|-----------------|
| APC     | Cromo pulido    |
| EB      | Bronce inglesa  |
| EG      | Oro inglés      |
| PN      | Níquel pulido   |
| STN     | Níquel satinado |
| ULB     | Latón sin lacar |

For warranty or additional information, contact:

U.S.A.  
houseofrohl.com/support  
1-800-777-9762

QUEBEC / MARITIMES / WESTERN CANADA  
QUÉBEC / MARITIMES / OUEST CANADIEN  
QUEBEC / MARITIMOS / CANADA OCCIDENTAL  
houseofrohl.ca/support  
1-866-473-8442

ONTARIO  
houseofrohl.ca/support  
1-800-287-5354